

Cooper Tire BTS

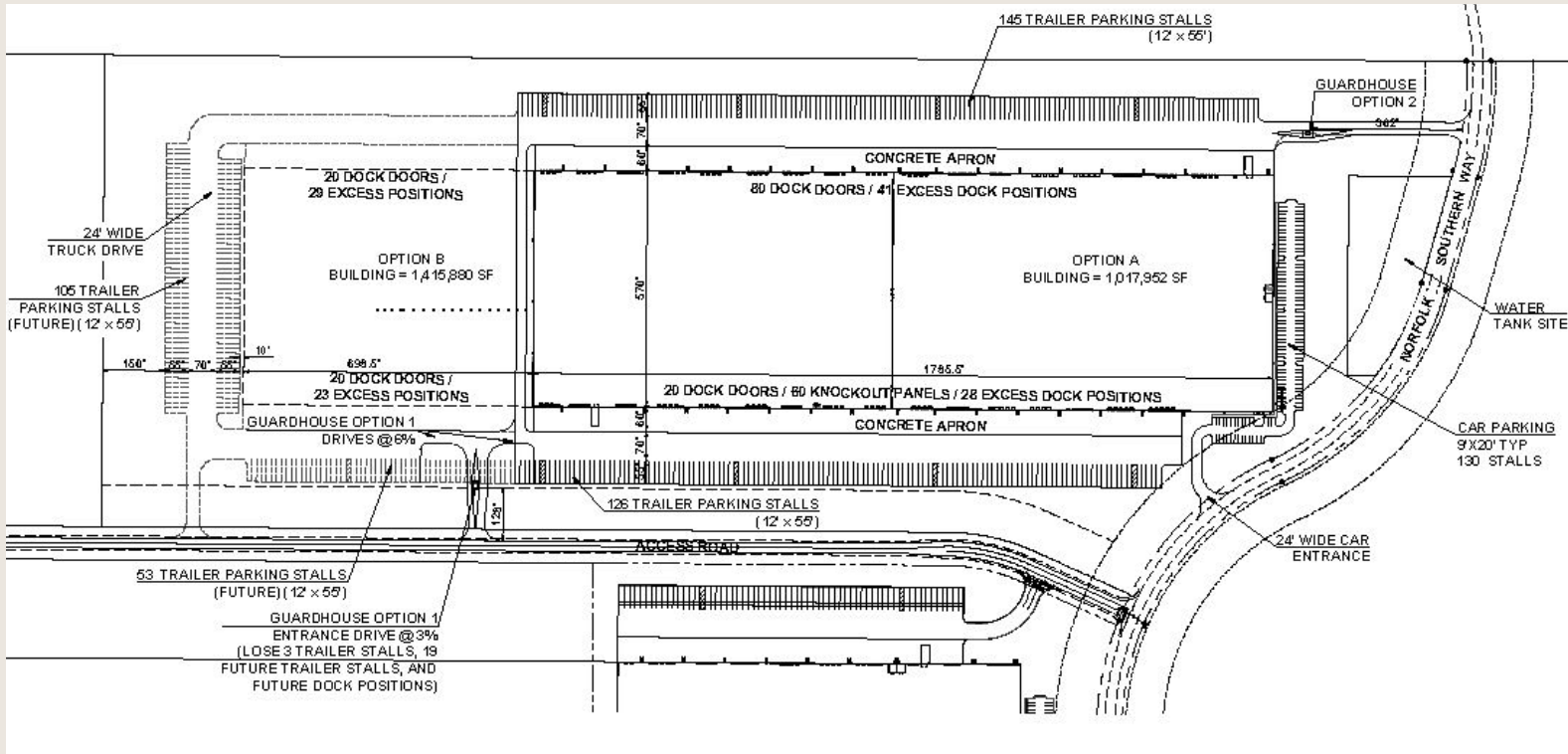

GATEWAY GLOBAL LOGISTICS CENTER
7521 HIGHWAY 72
MARSHALL COUNTY, MISSISSIPPI



LOCATION

- Market: SE Memphis
- Panattoni Local Partner: Whitfield Hamilton

RELEVANT PROJECT FEATURES

- 1,015,740 SF Distribution Facility BTS for Cooper Tire
- 82.00 Acre Site
- Construction Commencement: December 2017
- Project Completion: November 2018
- 32' Clear Height